

M2M³ M2M³FD M2M³SUB



M2M³



M2M³ doorsets certified by the Loss Prevention Certification Board (LPCB) to LPS1175 (Issue 7) Security Rating 3.

Note: Security rating can be affected by doorset sizing and configurations.

Specification



revA



DOCUMENT ISSUE : revE (03/10/2016)
 DATE : 05/10/2015
 AUTHOR : PWS

This document describes all **M2M³** options which can currently be offered with full certification.

1) Scope

- a. Single outward opening doorsets
- b. Double outward opening doorsets
- c. Single outward opening doorsets with removable overpanel¹
- d. Double outward opening doorsets with removable overpanel¹
- e. Single inward opening doorsets
- f. Double inward opening doorsets

2) Certified Sizing

(All sizes shown are structural sizes)

Variant		Min Height	Max Height	Min Width	Max Width
MICO ABRYLL SINGLE POINT LOCKING	Single outward opening doorsets	1000	2930	600	1430
	Double outward opening doorsets	1000	2930	900	2600
	Single inward opening doorsets	1000	2430	600	1430
	Single outward opening doorsets	1000	2430	900	1430
	Single outward opening doorsets with removable overpanel	1200	4125	600	1430
	Double outward opening doorsets with removable overpanel	1200	4125	900	2600
MICO 942 LOCKING	Single outward opening doorsets	1745	2430	740	1180
	Double outward opening doorsets	1745	2430	900	2200

Note: Double doorsets are available with unequal splits. Minimum passive leaf width 450mm.

¹ Only available on doors fitted with Mico Abryll single point locks.

3) Locking Options

- Single Point Locking – Mico Abryll
 - a. Full range of Panic, Manual, Automatic and Electromechanical deadlocking options
 - b. External access via Mico USCH cylinder guard with Scan oval cylinders as standard
 - c. Available also to suit round or rim cylinders
 - d. Passive leaf fitted with heavy duty tower bolts as standard. Tower bolts extended on larger doorsets to reachable height
 - e. Double panic bar variant also available (panic bars to both leaves)
- Multipoint Locking – Mico 942 Range (available as 2 or 3 point options)
 - a. Full range of Panic, Manual, Automatic and Electromechanical deadlocking options
 - b. External access via Mico USCH cylinder guard, fitted as standard with Scan oval cylinders. Mico ELK3 can be supplied for use with Panic Escape variants
 - c. Passive leaf fitted with heavy duty tower bolts, or secondary multipoint lock

4) Additional Options

- a. Vision panels² (standard sizes 230 x 356, 203 x 762, or 457 x 457)
- b. Punched and bladed louvre cartridges²
- c. Range of stays and closers. TS83 and Z108 as standard
- d. Fixed side and removable panels³

5) Fire Rating⁴

All options are available with up to 240 minute fire-rating, certified under Exova Certifire scheme (certificate number CF5107). The following exceptions apply:

- a. 2-point systems are not covered, these should be supplied as a 3-point variant
- b. Doors fitted with removable overpanels
- c. Vision panels reduce the fire rating to 60 minutes
- d. Doors with louvres

6) Leaf Construction

- a. Leaf thickness - 66mm
- b. Leaf material - Outerskins 1.5mm Zintec
- c. Reinforcing - Internal plating to suit locking requirement
- Armoured steel where required
- d. Hinges - 6no. hinges per leaf
- Choice of 126mm lift off hinge or Grade 13 butt hinge
- Protected by 9no. dog bolts per leaf
- e. Astragal - 10mm steel astragal

² Availability and positions of vision panels and louvres will be restricted by locking choice

³ Side and over panels are successfully tested but not yet covered by full certification

⁴ Fire rated doors must be fitted with Certifire approved door closers to each leaf (e.g. Dorma TS83)

7) Frame Construction

- | | | |
|------------------------|---|--|
| a. Frame profile | - | 110mm deep |
| b. Frame material | - | 2.0mm Zintec |
| c. Construction method | - | Butt jointed frame sections as standard |
| | - | Fully welded frame available at extra cost |
| d. Reinforcing | - | 3mm chassis system (no adjusters) |
| e. Threshold | - | Steel or aluminium options available |
| | - | No sill option available ⁶ |

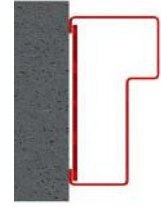

Frame profile

8) Standard Details

- | | | |
|------------------------|---|--|
| a. Finish | - | Polyester powder coated |
| | - | Range of colours and finishes available to suit client specification |
| | - | ExtraLife system also available, offering up to 10 year anti-rust warranty |
| b. U'value | - | No data available |
| c. Weight ⁵ | - | circa 75kg/m ² |

⁶ Only available with certain hardware options.

⁵ Weight figure should be used as an indicative value only; choice of hardware (e.g. vision panels) can adjust the weight considerably.